



FREE FLOAT STEAM TRAP

MODEL JH3LB

FREE FLOAT STEAM TRAP WITH THERMOSTATIC AIR VENTING

Features

Inline repairable stainless steel steam trap for drainage of superheated or high-pressure steam mains and equipment.

1. Self-modulating free float provides continuous, smooth, low velocity condensate discharge as process loads vary.
2. Precision-ground float, constant water-seal and unique three-point seating ensure steam-tight seal, even under no-load conditions.
3. Only one moving part, the free float, eliminates concentrated wear and provides long maintenance-free service life.
4. Thermostatic bimetal air vent valve vents air automatically for rapid start-up.
5. Easy, inline access to internal parts simplifies cleaning and reduces maintenance costs.
6. Built-in screen with large surface ensures trouble-free operation.



Specifications

Model		JH3LB		
Connection		Screwed	Socket Welded	Flanged
Size (mm)		15, 20, 25		
Orifice No.		2, 5, 10, 14, 22, 32		
Maximum Operating Pressure (MPaG)	PMO	0.2, 0.5, 1.0, 1.4, 2.2, 3.2		
Maximum Differential Pressure (MPa)	ΔPMX	0.2, 0.5, 1.0, 1.4, 2.2, 3.2		
Minimum Operating Pressure (MPaG)		0.01		
Maximum Operating Temperature (°C)	TMO	350		

1 MPa = 10.197 kg/cm²

PRESSURE SHELL DESIGN CONDITIONS (**NOT** OPERATING CONDITIONS): Maximum Allowable Pressure (MPaG) PMA: 3.2
Maximum Allowable Temperature (°C) TMA: 350



To avoid abnormal operation, accidents or serious injury, DO NOT use this product outside of the specification range. Local regulations may restrict the use of this product to below the conditions quoted.

No.	Description	Material	JIS	ASTM/AISI*
①	Body	Cast Stainless Steel	—	A351 Gr. CF8
②	Cover	Cast Stainless Steel	—	A351 Gr. CF8
③ ^F	Float	Stainless Steel	SUS316L	AISI316L
④ ^R	Orifice	—	—	—
⑤ ^{MR}	Orifice Gasket	Stainless Steel	SUS316L	AISI316L
⑥	Orifice Plug	Stainless Steel	SUS303	AISI303
⑦ ^{MR}	Plug Gasket	Stainless Steel	SUS316L	AISI316L
⑧ ^{MR}	Cover Gasket	Stainl. Steel/Graphite	SUS316L	AISI316L
⑨ ^R	Float Cover	Stainless Steel	SUS304	AISI304
⑩ ^R	Screen	Stainless Steel	SUS430	AISI430
⑪ ^R	Snap Ring	Stainless Steel	SUS304	AISI304
⑫ ^R	Air Vent Screen	Stainless Steel	SUS304	AISI304
⑬ ^R	Snap Ring	Stainless Steel	SUS304	AISI304
⑭ ^R	Air Vent Valve Plug	Stainless Steel	SUS416	AISI416
⑮ ^R	Air Vent Valve Seat	Stainless Steel	SUS303	AISI303
⑯ ^R	Bimetal Plate	Bimetal	—	—
⑰ ^R	Air Vent Case	Cast Stainless Steel	—	A351 Gr. CF8
⑱	Cover Bolt	Stainless Steel	SUS304	AISI304
⑲	Connector	Stainless Steel	SUS416	AISI416
⑳	Socket**	Cast Stainless Steel	—	A351 Gr. CF8
	Flange**	Cast Stainless Steel	—	A351 Gr. CF8
㉑	Nameplate	Stainless Steel	SUS304	AISI304
㉒	Drain Plug Gasket***	Stainless Steel	SUS316L	AISI316L
㉓	Drain Plug***	Stainless Steel	SUS303	AISI303

* Equivalent ** Shown on reverse, sockets 25 mm are welded on *** Option
Replacement kits available: (M) maintenance parts, (R) repair parts, (F) float

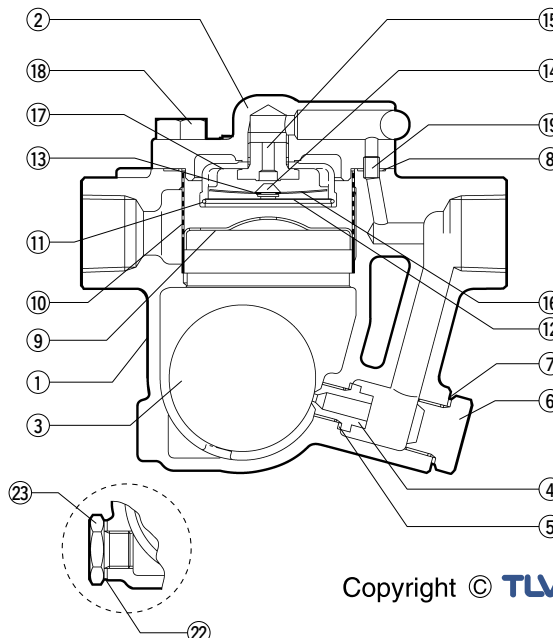

Copyright © TLV

Dimensions

● **JH3LB Screwed**

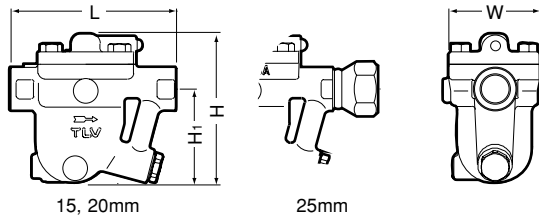

JH3LB Screwed* (mm)

Size	L	H	H ₁	W	Weight (kg)
15	145	129	82	80	2.7
20					2.8
25	203				

* Rc(PT), other standards available

● **JH3LB Socket Welded**

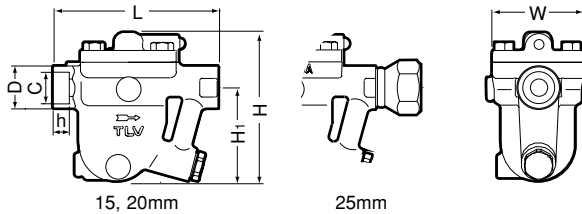

JH3LB Socket Welded (mm)

Size	L	H	H ₁	W	φD	φC	h	Weight (kg)
15	145	129	82	80	36	22.2	12	2.7
20							14	
25	203				44	34.5		2.8

● **JH3LB Flanged**

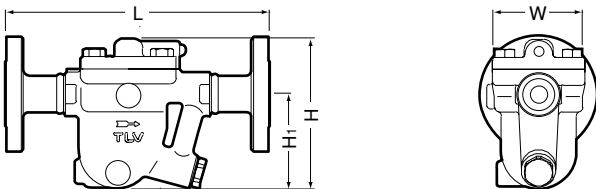

JH3LB Flanged (mm)

Size	L			H	H ₁	W	Weight* (kg)
	ASME Class						
	150RF	300RF	600RF				
15	210	210	220	129	82	80	4.3
20	230	230	230				5.1
25	250	250	250				5.8

Other standards available, but length and weight may vary
* Weight is for class 600 RF

Discharge Capacity

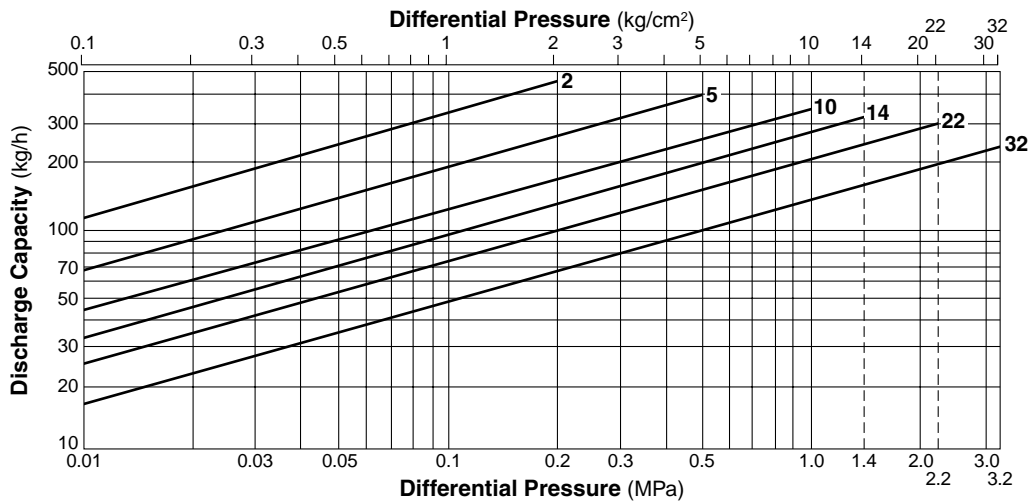

1. Line numbers within the graph refer to orifice numbers.
2. Differential pressure is the difference between the inlet and outlet pressure of the trap.
3. Capacities are based on continuous discharge of condensate 6°C below saturated steam temperature.
4. Recommended safety factor: at least 1.5.

CAUTION DO NOT use traps under conditions that exceed maximum differential pressure, as condensate backup will occur!

Manufacturer

ISO 9001/ISO 14001

TLV® CO., LTD.
Kakogawa, Japan
is approved by LRQA Ltd. to ISO 9001/14001

