



CHECK VALVE

MODEL CK3M/CK3T/CK3R

DISC TYPE CHECK VALVE WITH SCREW CONNECTION

Features

Compact check valve for steam, air, water and other fluid services.

1. Fine-machined metal, fluorine resin or nitrile rubber valve seat provides tight closure.
2. Corrosion resistant body material and stainless steel internal parts ensure long service life.
3. Performance assured with installation in either horizontal or vertical pipelines.



Specifications

Model	CK3M			CK3T			CK3R		
	Screwed								
Connection	Screwed								
Size	15-25	32-50	15-50	15-25	32-50	15-50	15-25	32-50	15-50
Body Material	Brass	Bronze	Stainless Steel	Brass	Bronze	Stainless Steel	Brass	Bronze	Stainless Steel
Sealing Surface	Brass	Bronze	Stainless Steel	Fluorine Resin			Nitrile Rubber		
Maximum Operating Pressure (MPaG) PMO	1.0		2.1	1.0		1.6	1.0		1.6
Minimum Opening Differential Pressure (MPa)	0.002								
Minimum Required Differential Pressure for Tight Sealing (MPa)	—						0.05		
Maximum Operating Temperature (°C) TMO	220			185			90		
Minimum Operating Temperature (°C)	-100*						-30*		
Application	Steam, Water and other liquids**						Air, Water and other fluids**		

* Subject to limitations of freezing point of fluid ** Do not use for toxic, flammable or otherwise hazardous fluids

1 MPa = 10.197 kg/cm²

PRESSURE SHELL DESIGN CONDITIONS (NOT OPERATING CONDITIONS):

Maximum Allowable Pressure (MPaG) PMA: 1.0 (Brass, Bronze), 2.1 (Stainless Steel)

Maximum Allowable Temperature (°C) TMA: 220



To avoid abnormal operation, accidents or serious injury, DO NOT use this product outside of the specification range. Local regulations may restrict the use of this product to below the conditions quoted.

No.	Description	Material	JIS	ASTM/AISI*
①	Valve Body (15-25)	Brass	C3604	B16 C36000
	Valve Body (32-50)	Bronze	CAC407	B584 C92200
	Valve Body (15-50)	Cast Stainless Steel	SCS13	A351 Gr.CF8
②	Inlet Union (15-25)	Brass	C3604	B16 C36000
	Inlet Union (32-50)	Bronze	CAC407	B584 C92200
	Inlet Union (15-50)	Cast Stainless Steel	SCS13	A351 Gr.CF8
③	Union Gasket	Fluorine Resin	PTFE	PTFE
④	Valve Disc (15-25)	Stainless Steel	SUS304	AISI304
	Valve Disc (32-50)	Cast Stainless Steel	SCS13	A351 Gr.CF8
⑤	Spring Holder	Stainless Steel	SUS304	AISI304
⑥	Coil Spring	Stainless Steel	SUS304	AISI304
⑦	Valve Seat (CK3T)	Fluorine Resin	PTFE	PTFE
	Valve Seat (CK3R)	Nitrile Rubber	NBR	D2000BF
⑦	Valve Seat (CK3M 15-25)	Brass	C3604	B16 C36000
	Valve Seat (CK3M 32-50)	Bronze	CAC407	B584 C92200
	Valve Seat (CK3M 15-50)	Cast Stainless Steel	SCS13	A351 Gr.CF8

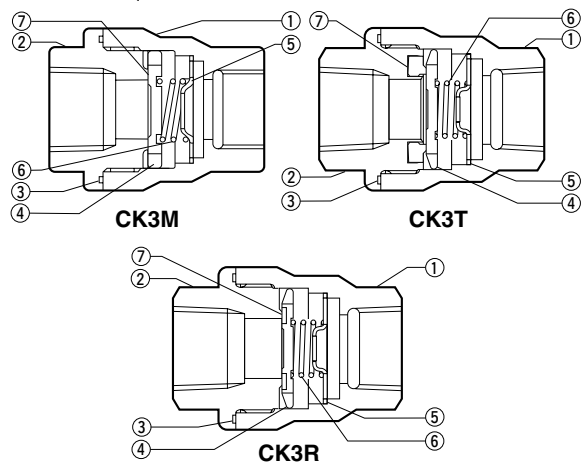

* Equivalent

Dimensions

● **CK3M/CK3T/CK3R** Screwed

CK3M/CK3T/CK3R Screwed* (mm)

Brass, Size 15–25

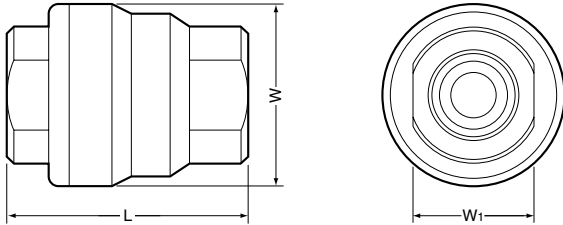

Size	L	ϕ W	W ₁	Weight (kg)
15	55	40	27	0.3
20	60	50	32	0.5
25	70	60	41	0.8
32	80	75	50	1.3
40	85	85	55	1.6
50	100	95	70	2.2

* Rc(PT), other standards available

Bronze, Size 32–50

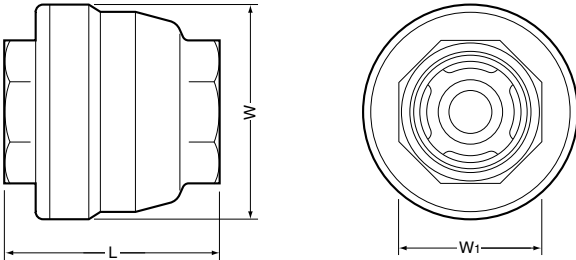

Stainless Steel, Size 15–50

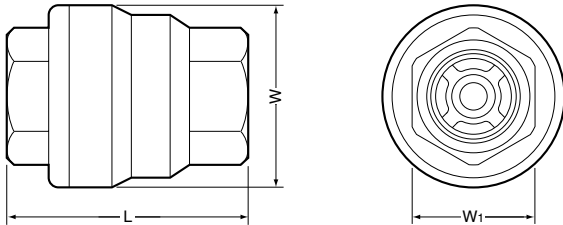

Cv Values

Size (mm)	15	20	25	32	40	50
Cv (US)	3.7	6.6	10	15	21	29
Cv (UK)	3.1	5.5	8.3	13	17	24
Kvs (DIN)	3.2	5.7	8.6	13	18	25

Manufacturer

ISO 9001/ISO 14001

TLV CO., LTD.
Kakogawa, Japan

is approved by LRQA Ltd. to ISO 9001/14001

