



# CHECK VALVE

## MODEL CK3MG STAINLESS STEEL

### HIGH-CAPACITY DISK TYPE CHECK VALVE WITH CENTER GUIDED VALVE DISC

#### Features

5`ghUJb`Ygg'ghY`W YW\_j Uj YZ:f'ghUa ž UbX'k UHy"

1. Fine-machined metal valve seat provides tight closure.
2. Stainless steel body and internal parts ensure long service life.
3. Smooth movement of the center guided valve disc further increases durability.
4. Low pressure drop due to large flow area.
5. Performance assured with installation in either horizontal or vertical pipelines.



#### Specifications

Model	CK3MG	
Connection	Screwed	
Size (mm)	1", 1½", 2", 3"	
Sealing Surface*	Stainless Steel	
Maximum Operating Pressure (barg)	PMO	21
Minimum Opening Differential Pressure** (bar)		0.01
Maximum Operating Temperature (°C)	TMO	220
Applicable Fluids***	Steam, Water	

\* Perfect sealing cannot be guaranteed for metal sealing surfaces.

1 bar = 0.1 MPa

\*\* When the valve has remained closed for a long period of time, the valve and the valve seat may stick, increasing the necessary minimum opening differential pressure.

\*\*\* Do not use for toxic, flammable or otherwise hazardous fluids

PRESSURE SHELL DESIGN CONDITIONS (NOT OPERATING CONDITIONS): Maximum Allowable Pressure (barg) PMA: 32  
Maximum Allowable Temperature (°C) TMA: 220



To avoid abnormal operation, accidents or serious injury, DO NOT use this product outside of the specification range. Local regulations may restrict the use of this product to below the conditions quoted.

No.	Description	Material	DIN	ASTM/AISI*
①	Valve Body	Cast Stainless Steel A351 Gr.CF8	1.4312	—
②	Inlet Union	Cast Stainless Steel A351 Gr.CF8	1.4312	—
③ <sup>R</sup>	Valve Disc	Stainless Steel SUS304	1.4301	AISI304
④ <sup>R</sup>	Coil Spring	Stainless Steel SUS304	1.4301	AISI304
⑤ <sup>MR</sup>	Union Gasket	Fluorine Resin PTFE	PTFE	PTFE
⑥	Nameplate	Stainless Steel SUS304	1.4301	AISI304

\* Equivalent materials

Replacement kits available: (M) maintenance parts, (R) repair parts

When requesting replacement kits, please specify the Minimum Opening Differential Pressure.

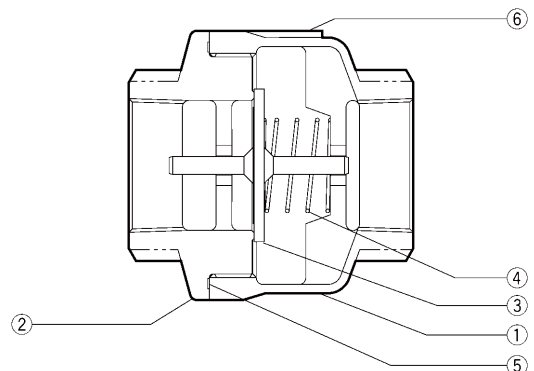

**Dimensions**

● **CK3MG** Screwed

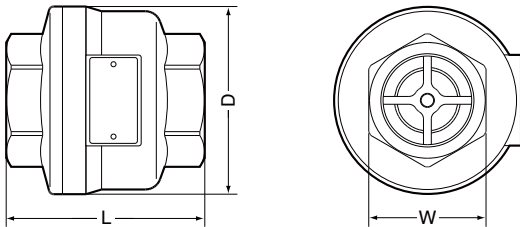

**CK3MG** Screwed\* (mm)

Size	L	φ D	W	Weight (kg)
1"	84	70	41	1.0
1½"	122	102	60	2.6
2"	127	120	75	3.7
3"	171	151	100	5.5

\* BSP DIN 2999, other standards available

**Cv & Kvs Values**

Size	1"	1½"	2"	3"
Kvs (DIN)	21	47	78	154
Cv (UK)	21	46	76	150
Cv (US)	25	55	91	180

Manufacturer

**TLV** CO., LTD.  
Kakogawa, Japan

is approved by LRQA Ltd. to ISO 9001/14001

ISO 9001/ISO 14001

