



FREE FLOAT[®] STEAM TRAP

MODEL JH7RH-B/JH7RH-W

FREE FLOAT STEAM TRAP WITH THERMOSTATIC AIR VENTING OR COVER CONNECTION

Benefits

A reliable and durable low alloy cast steel steam trap for use on medium-size process equipment, also suitable for both superheated and extremely high-pressure applications.

1. Self-modulating free float provides continuous, smooth, low-velocity condensate discharge as process loads vary.
2. Precision-ground float, constant water seal and three-point seating design ensure a steam-tight seal, even under no-load conditions.
3. Rugged float construction with up to 2850 psig hydraulic shock rating ensures excellent resistance of the float to water hammer.
4. **JH7RH-B**: Thermostatic bimetal air vent valve vents air automatically for rapid startup.
5. **JH7RH-W***: Instead of the bimetal air vent, for higher pressure and temperature applications, the JH7RH-W manufactured with a cover socket connection.
6. Built-in screen with large surface area ensures extended trouble-free operation.
7. Easy, inline access to internal parts simplifies cleaning and reduces maintenance costs.

* Option

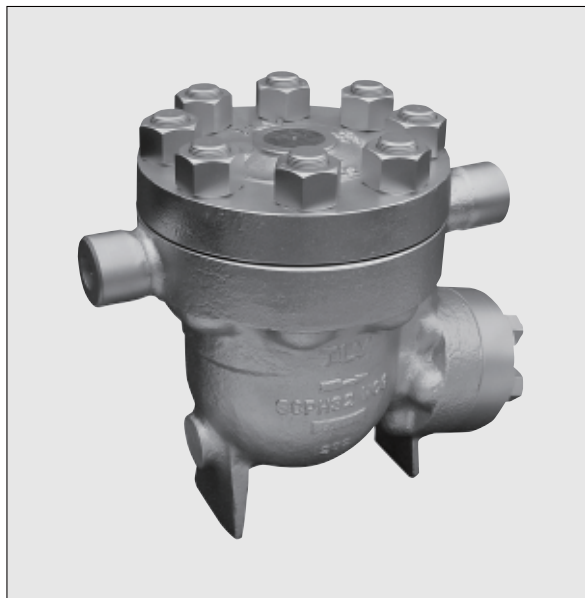

Specifications

Model	JH7RH-B	JH7RH-W (option)
Connection	Socket Weld	Socket Weld
Size (in)	1	1
Orifice No.	80, 100	100, 120
Maximum Operating Pressure (psig) PMO	1150, 1500	1500, 1740
Maximum Differential Pressure (psi) ΔPMX	1150, 1500	1500, 1740
Minimum Operating Pressure (psig)	1.5	Vacuum
Maximum Operating Temperature (°F) TMO	800	986
Maximum Allowable Pressure (psig) PMA	1740	1740
Maximum Allowable Temperature (°F) TMA	800	986
Type of Air Vent	Bimetal (vents air up to approx. 212 °F)	—

No.	Description	Material	ASTM/AISI*	JIS
①	Body	Low Alloy Cast Steel	A217 Gr.WC9	—
②	Cover	Low Alloy Cast Steel	A217 Gr.WC9	—
③ ^F	Float	Stainless Steel	AISI316L	SUS316L
④ ^R	Orifice	—	—	—
⑤ ^{MR}	Orifice Gasket	Graphite/Stainless Steel	- /AISI316	- /SUS316
⑥ ^R	Orifice Locknut	Stainless Steel	AISI303	SUS303
⑦ ^{MR}	Outlet Cover Gasket	Graphite/Stainless Steel	- /AISI309S+cb	- /SUS309S+cb
⑧	Outlet Cover	Stainless Steel	AISI420	SUS420J2
⑨	Cover Bolt	Alloy Steel	A193 Gr.B16	SNB16
⑩	Cover Nut	Alloy Steel	A193 Gr.B7	SNB7
⑪ ^{MR}	Cover Gasket	Graphite/Stainless Steel	- /AISI309S+cb	- /SUS309S+cb
⑫	Outlet Cover Bolt	Alloy Steel	A193 Gr.B16	SNB16
⑬	Outlet Cover Nut	Alloy Steel	A193 Gr.B7	SNB7
⑭ ^R	Screen	Stainless Steel	AISI430	SUS430
⑮	Screen Holder	Stainless Steel	AISI304	SUS304
⑯	Snap Ring	Stainless Steel	AISI304	SUS304
⑰	Screen Holder Retainer	Stainless Steel	AISI304	SUS304
⑱	Nameplate	Stainless Steel	AISI304	SUS304
⑲ ^R	Bimetal Air Vent Unit	—	—	—
⑳	Air Vent Guide	Stainless Steel	AISI303	SUS303
㉑ ^{MR}	Air Vent Unit Gasket	Stainless Steel	AISI316L	SUS316L
㉒	Cover Socket	Alloy Steel	A182 F22 Cl.3	—

* Equivalent
Replacement kits available: (M) maintenance parts, (R) repair parts, (F) float

Connections and sizes in bold are standard



To avoid abnormal operation, accidents or serious injury, DO NOT use this product outside of the specification range. Local regulations may restrict the use of this product to below the conditions quoted.

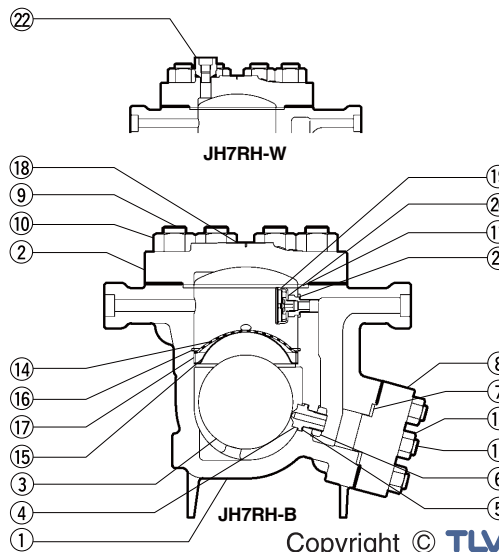

Dimensions

● **JH7RH-B/JH7RH-W Socket Weld**

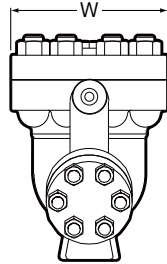
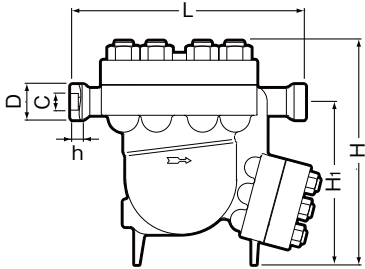

JH7RH-B/JH7RH-W Socket Weld* (in)

Size	L	H	H ₁	φW	φD	φC	h	Weight (lb)
1	15 3/8	14 5/8 (15)	10 5/8	10 1/8	2 1/8	1.330	1/2	189

* ASME B16.11-2005, other standards available
() JH7RH-W

● **JH7RH-W**

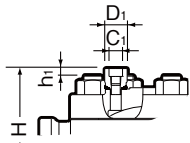

JH7RH-W Cover Socket* (in)

φD ₁	φC ₁	h ₁
1 7/16	0.855	1/2

* ASME B16.11-2005, other standards available

Discharge Capacity

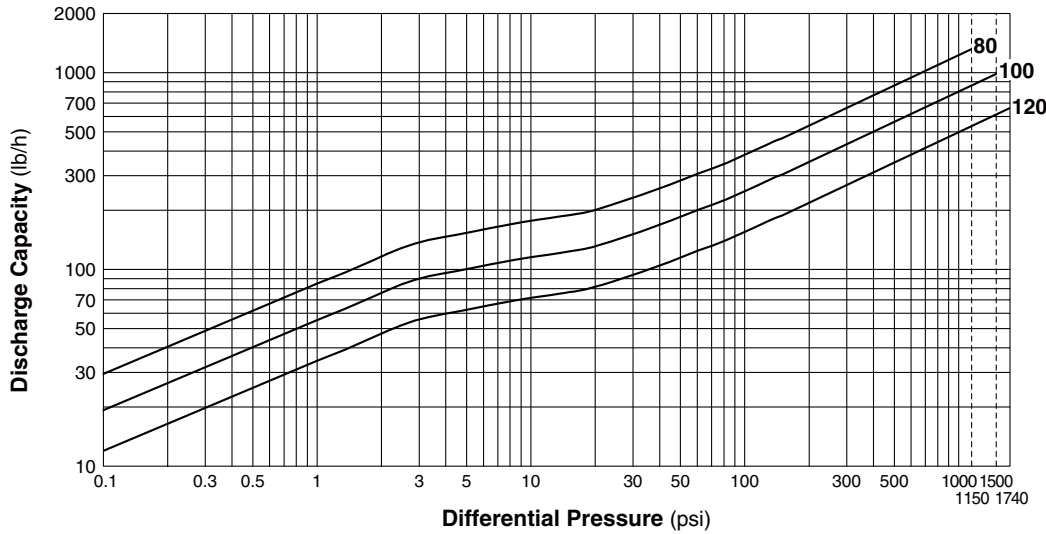

1. Line numbers within the graph are orifice numbers.
2. Differential pressure is the difference between the inlet and outlet pressure of the trap.
3. Capacities are based on continuous discharge of condensate 11 °F below saturated temperature.
4. Recommended safety factor: at least 1.5.

CAUTION DO NOT use traps under conditions that exceed maximum differential pressure, as condensate backup will occur!

CAUTION DO NOT DISASSEMBLE OR REMOVE THIS PRODUCT WHILE IT IS UNDER PRESSURE. Allow internal pressure of this product to equal atmospheric pressure and its surface to cool to room temperature before disassembling or removing. Failure to do so could cause burns or other injury. READ INSTRUCTION MANUAL CAREFULLY.

TLV CORPORATION

13901 South Lakes Drive, Charlotte, NC 28273-6790
 Phone: 704-597-9070 Fax: 704-583-1610
 E-mail: tlv@tlvengineering.com
 For Technical Service 1-800 "TLV TRAP"



Manufacturer
TLV CO., LTD.
 Kakogawa, Japan
 is approved by LRQA Ltd. to ISO 9001/14001

ISO 9001/ISO 14001

