



PROCESS FLOAT STEAM TRAP

MODEL JLH15

HIGH-CAPACITY STEEL FLOAT STEAM TRAP WITH THERMOSTATIC AIR VENTING

Benefits

Extremely durable, inline-repairable, compact float trap with thermostatic air venting for large process or heating equipment.

1. Double-seated valve with heat-treat hardened valve seat and valve head provides continuous, smooth, low-velocity condensate discharge as process loads vary.
2. Self-aligning valve mechanism with stainless steel internals minimizes wear.
3. Thermostatic bimetal air vent valve vents air automatically for rapid startup.
4. Easy, inline access to internal parts simplifies cleaning and reduces maintenance costs.
5. High-quality stainless steel internals and hardened valve surfaces ensure reliability.
6. The built-in screen eliminates the need for an external strainer.



Specifications

Model	JLH15
Connection	Flanged
Size (in)	3
Orifice No.	50
Maximum Operating Pressure (psig) PMO	710
Maximum Differential Pressure (psi) ΔPMX	710
Minimum Operating Pressure (psig)	Vacuum (1.5)
Maximum Operating Temperature (°F) TMO	800
Maximum Allowable Pressure (psig) PMA	710
Maximum Allowable Temperature (°F) TMA	800

Connections and sizes in bold are standard



To avoid abnormal operation, accidents or serious injury, DO NOT use this product outside of the specification range. Local regulations may restrict the use of this product to below the conditions quoted.

No.	Description	Material	ASTM/AISI*	JIS
①	Body	Cast Steel	A216/A216M Gr.WCB	—
②	Cover	Cast Steel	A216/A216M Gr.WCB	—
③ ^{MR}	Cover Gasket	Graphite/Stainless Steel	— / AISI316L	— / SUS316L
④	Cover Bolt	Alloy Steel	A193/A193M Gr.B16	—
⑤	Cover Nut	Carbon Steel	A194/A194M Gr.2H	—
⑥ ^{FR}	Float / Lever Unit	Stainless Steel / Cast Stainless Steel	AISI316L / A351/A351M Gr.CF8	SUS316L / —
⑦ ^{MR}	Trap Unit (Main Valve Unit)	Stainless Steel / Cast Stainless Steel	AISI304 / A743/A743M Gr. CA40	SUS304 / —
⑧ ^R	Air Vent Unit	Stainless Steel	AISI304/420F	SUS304/420F
⑨ ^R	Screen	Stainless Steel	AISI304	SUS304
⑩	Screen Holder	Cast Steel	A216/A216M Gr.WCB	—
⑪ ^{MR}	Screen Holder Gasket	Graphite/Stainless Steel	— / AISI304	— / SUS304
⑫	Screen Holder Bolt	Cast Steel	A193/A193M Gr.B16	—
⑬	Screen Holder Nut	Carbon Steel	A194/A194M Gr.2H	—
⑭	Cover Plug	Carbon Steel	A105/A105M	—
⑮ ^M	Cover Plug Gasket	Stainless Steel	AISI1010	SUYP
⑯	Nameplate	Stainless Steel	AISI304	SUS304
⑰	Eye Bolt	Stainless Steel	A307 Gr.B	SS400
⑱	Outlet Pipe	Stainless Steel	AISI304	SUS304
⑲	Snap Ring	Stainless Steel	AISI304	SUS304
⑳	Drain Plug	Carbon Steel	A105/A105M	—
㉑ ^M	Drain Plug Gasket	Stainless Steel	AISI1010	SUYP

* Equivalent

Replacement kits available: (M) maintenance parts, (R) repair parts, (F) float

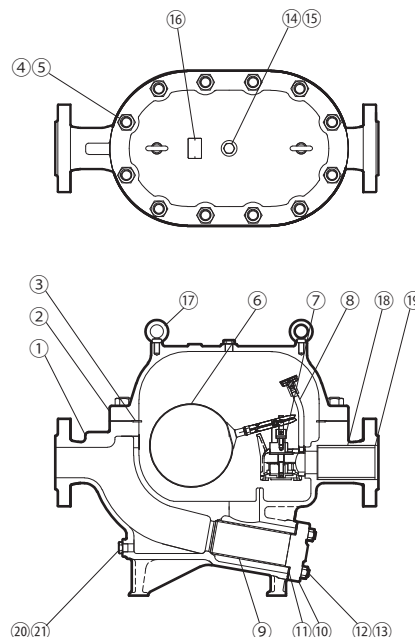

Dimensions

• JLH15 Flanged

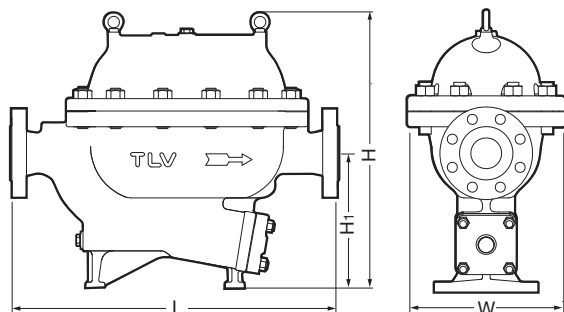

JLH15 Flanged (in)

Size	L		H*	H ₁	W	Weight (lb)
	Connects to ASME Class					
	300RF	600RF				
3	33½	33½	28½	13¾	16 ¹ / ₁₆	485

* Approx.
Other standards available, but length and weight may vary

Flange classes in bold are standard

Discharge Capacity

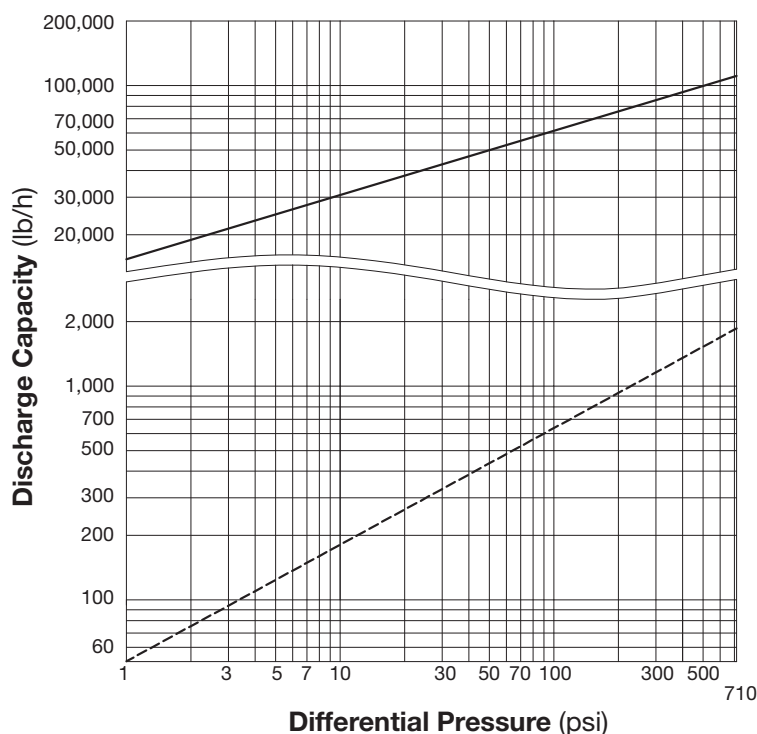

— : Maximum capacity
- - - : Minimum amount of condensate required to prevent steam leakage

1. Line numbers within the graph refer to orifice numbers.
2. Differential pressure is the difference between the inlet and outlet pressure of the trap.
3. Capacities are based on continuous discharge of condensate 11 °F below saturated steam temperature.
4. Recommended safety factor: at least 1.5.



DO NOT use this product under conditions that exceed maximum differential pressure, as condensate backup will occur!



DO NOT DISASSEMBLE OR REMOVE THIS PRODUCT WHILE IT IS UNDER PRESSURE.
Allow internal pressure of this product to equal atmospheric pressure and its surface to cool to room temperature before disassembling or removing. Failure to do so could cause burns or other injury. READ INSTRUCTION MANUAL CAREFULLY.

TLV CORPORATION

13901 South Lakes Drive, Charlotte, NC 28273-6790
Tel: 704-597-9070 Fax: 704-583-1610
E-mail: tlv@tlvengineering.com <https://www.tlv.com>
For Technical Service 1-800 "TLV TRAP"



Manufacturer
TLV CO., LTD.
Kakogawa, Japan
is approved by LRQA Ltd. to ISO 9001/14001

ISO 9001
ISO 14001

