



# BALANCED PRESSURE THERMOSTATIC STEAM TRAP

## MODEL LV8/LV8-HC

### BALANCED PRESSURE THERMOSTATIC STEAM TRAP WITH "FAIL-OPEN" DESIGN

#### Benefits

All stainless steel thermostatic trap suitable for applications where the condensate load is relatively small, e.g. tracing, vessels and heaters. Preferably for vertical installation.

1. "Fail open" feature.
2. Rugged yet light construction withstands superheat and water hammer.
3. Cyclic operation with fixed subcooling throughout entire pressure range.
4. Outstanding air venting capability.
5. Compact, yet high capacity.
6. Easy to maintain and easy to clean.
7. Hardened stainless steel valve surfaces.
8. Built-in screen with large surface area.



#### Specifications

Model	LV8	LV8-HC
Connection	Screwed	
Size (in)	1/4", 3/8", 1/2", 3/4", 1"	1/2", 3/4", 1"
Max. Operating Press. (psig) PMO	115	
Min. Operating Press. (psig)	Vacuum	
Maximum Back Pressure	90% of Inlet Pressure	
Max. Operating Temp. (°F) TMO	see graph at right	
Max. Allowable Pressure (psig) PMA	350	
Max. Allowable Temperature (°F) TMA	800	
Subcooling of X-element Fill (°F)	up to 3.6 (option: up to 11)	up to 3.6
Type of X-element	C2C (option: C6)	C2HC

LV8, LV8-HC are non-standard products, consult TLV for delivery time required.

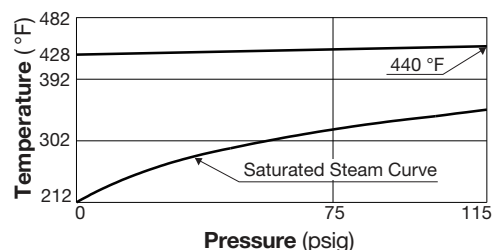

To avoid abnormal operation, accidents or serious injury, DO NOT use this product outside of the specification range. Local regulations may restrict the use of this product to below the conditions quoted.

No.	Description	Material	ASTM/AISI*	JIS
①	Body	Cast Stainless Steel	A351/A351M Gr.CF8	—
②	Cover	Cast Stainless Steel	A351/A351M Gr.CF8	—
③	X-element	Stainless Steel	—	—
④	Valve Seat	Stainless Steel	AISI316L	SUS316L
⑤	Screen	Stainless Steel	AISI304	SUS304
⑥	Nameplate	Stainless Steel	AISI304	SUS304

\* Equivalent

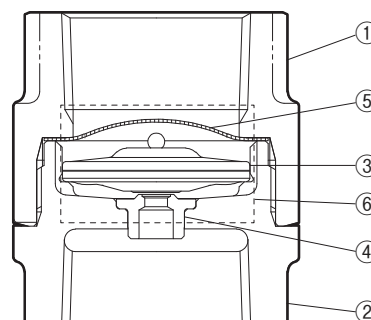

## Dimensions

### • LV8/LV8-HC Screwed

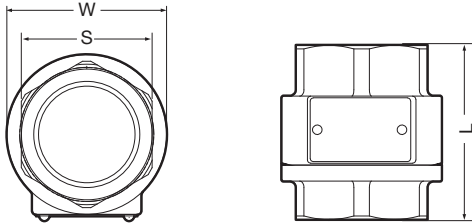

### LV8/LV8-HC Screwed\* (in)

Size	L	φ W	S	Weight (lb)
1/4 **	2 <sup>3</sup> / <sub>16</sub>	2	1 <sup>1</sup> / <sub>16</sub>	0.9
3/8 **				
1/2				
3/4			1 <sup>5</sup> / <sub>8</sub>	1.2
1				1.1

\* NPT, other standards available

\*\* LV8 only

## Discharge Capacity

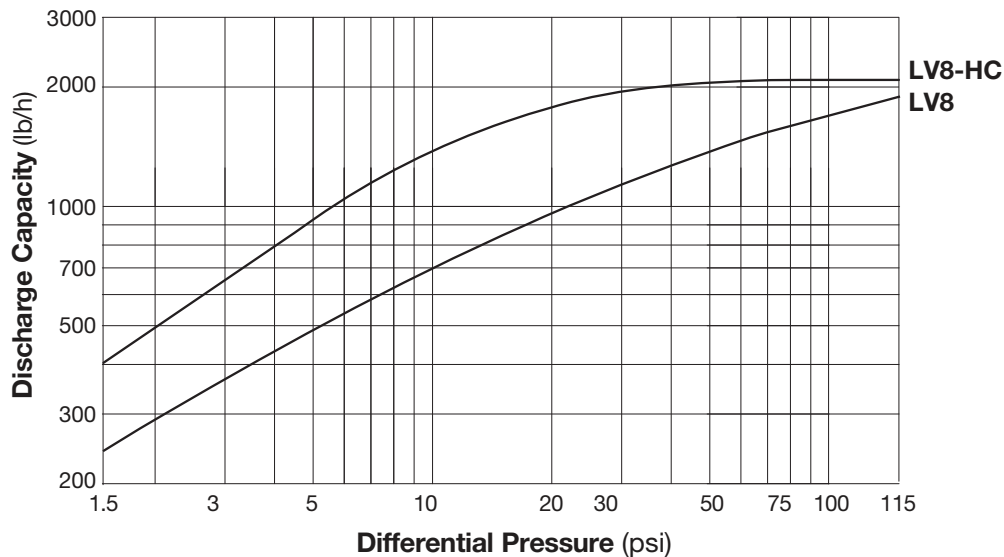

1. Differential pressure is the difference between the inlet and outlet pressure of the trap.
2. Recommended safety factor: at least 2.



**CAUTION**

DO NOT DISASSEMBLE OR REMOVE THIS PRODUCT WHILE IT IS UNDER PRESSURE.

Allow internal pressure of this product to equal atmospheric pressure and its surface to cool to room temperature before disassembling or removing. Failure to do so could cause burns or other injury. READ INSTRUCTION MANUAL CAREFULLY.

## TLV CORPORATION

13901 South Lakes Drive, Charlotte, NC 28273-6790  
 Tel: 704-597-9070 Fax: 704-583-1610  
 E-mail: [tlv@tlvengineering.com](mailto:tlv@tlvengineering.com) <https://www.tlv.com>  
 For Technical Service 1-800 "TLV TRAP"



Manufacturer

**TLV** CO., LTD.

Kakogawa, Japan

is approved by LRQA Ltd. to ISO 9001/14001

ISO 9001  
ISO 14001

