



RAPID INITIAL AIR VENT

MODEL VS1A-M2

RAPID INITIAL AIR VENT FOR HIGH TEMPERATURE LIQUIDS

Benefits

Stainless steel air vent installs vertically in liquid systems. Vents large volumes of initial air from liquids above 0.8 S.G.*

1. Precision-ground float, three-point seating and valve seat with rubber contact ensure superior sealing.
2. Up to 1740 psig hydraulic shock rating ensures excellent durability of the float.
3. Unique rotational seating design prevents concentrated wear.
4. Dual air vent and vacuum breaker capability lowers installation costs.
5. Optional high temperature stainless steel valve seat available.**

* Consult TLV for specific gravities lower than 0.8

** Sealing effectiveness may be slightly lowered.



Specifications

Model		VS1A-M2
Connection		Screwed
Size (in)		1/2, 3/4, 1
Orifice No.		21
Maximum Operating Pressure (psig)	PMO	300
Minimum Operating Pressure (psig)		1.5
Maximum Operating Temperature (°F)	TMO	302 (428 with optional metal seat**)
Maximum Allowable Pressure (psig)	PMA	300
Maximum Allowable Temperature (°F)	TMA	428
Applicable Fluids*		Water, Other Liquids

* Do not use for toxic, flammable, or otherwise hazardous fluids

VS1A is a non-standard product, consult TLV for delivery time required.

** Maximum valve leak rate: 1 lb/h

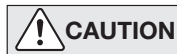

To avoid abnormal operation, accidents or serious injury, DO NOT use this product outside of the specification range. Local regulations may restrict the use of this product to below the conditions quoted.

No.	Description	Material	ASTM/AISI*	JIS
①	Body	Cast Stainless Steel	A351/A351M Gr.CF8	—
②	Cover	Cast Stainless Steel	A351/A351M Gr.CF8	—
③	Float	Stainless Steel	AISI316L	SUS316L
④	Valve Seat	Fluorine Rubber/Stainless Steel	D2000HK/AISI303	FPM/SUS303
⑤	Valve Seat Gasket	Fluorine Resin	—	PTFE
⑥	Cover Gasket	Fluorine Resin	—	PTFE
⑦	Cover Bolt	Stainless Steel	—	—
⑧	Nameplate	Stainless Steel	AISI304	SUS304
⑨	Connector	Stainless Steel	AISI304	SUS304
⑩	Screw	Stainless Steel	AISI304	SUS304
⑪	Spring Washer	Stainless Steel	AISI304	SUS304
⑫	Guide Plate	Stainless Steel	AISI304	SUS304

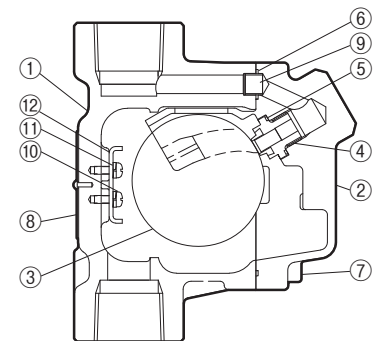

* Equivalent

Dimensions

● **VS1A-M2** Screwed

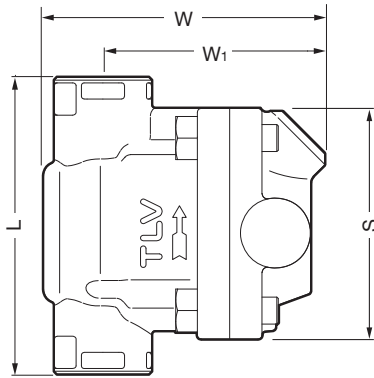

VS1A-M2 Screwed*

(in)

Size	L	W	W ₁	S	Weight (lb)
1/2	4 ⁵ / ₁₆	4 ⁵ / ₁₆	3 ³ / ₈	3 ³ / ₈	3.3
3/4	4 ³ / ₄				
1	5 ¹ / ₈				3.7

* NPT, other standards available

Discharge Capacity

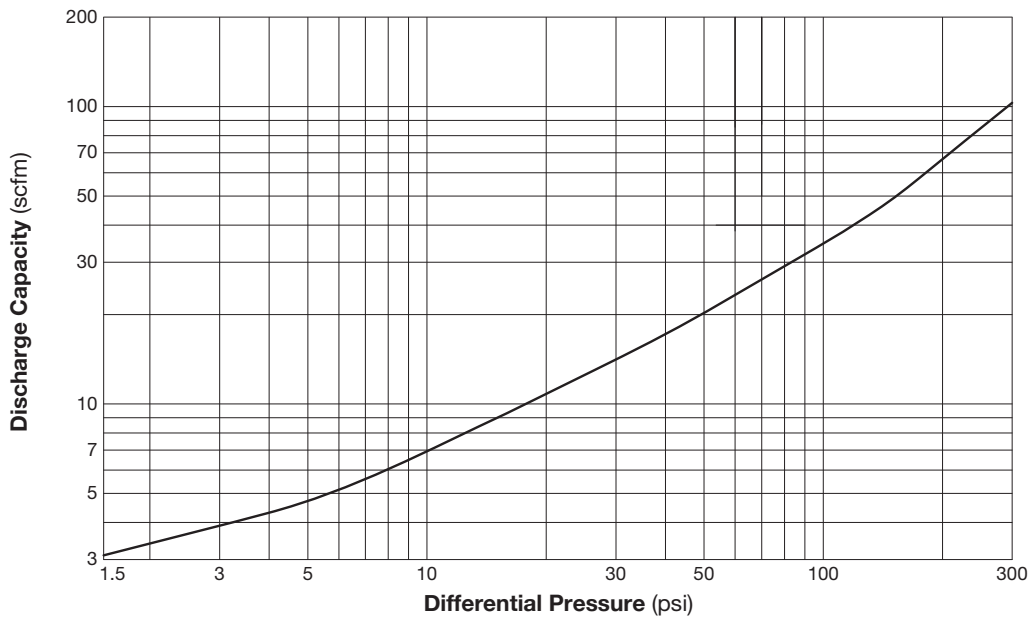

1. Differential pressure is the difference between the inlet and outlet pressure of the air vent.
2. Capacities are equivalent capacities of air at 68 °F under atmospheric pressure.



Once the valve closes after discharging initial air, it will not open again, even if air accumulates inside the product, until internal pressure drops to near atmospheric pressure.



DO NOT DISASSEMBLE OR REMOVE THIS PRODUCT WHILE IT IS UNDER PRESSURE. Allow internal pressure of this product to equal atmospheric pressure and its surface to cool to room temperature before disassembling or removing. Failure to do so could cause burns or other injury. READ INSTRUCTION MANUAL CAREFULLY.

TLV CORPORATION

13901 South Lakes Drive, Charlotte, NC 28273-6790

Tel: 704-597-9070 Fax: 704-583-1610

E-mail: tlv@tlvengineering.com <https://www.tlv.com>

For Technical Service 1-800 "TLV TRAP"



Manufacturer

TLV CO., LTD.

Kakogawa, Japan

is approved by LRQA Ltd. to ISO 9001/14001

ISO 9001
ISO 14001

