



# PROCESS FLOAT STEAM TRAP

## MODEL JLH15

### HIGH-CAPACITY STEEL FLOAT STEAM TRAP WITH THERMOSTATIC AIR VENTING

#### Features

**Extremely durable, inline-repairable, compact float trap with thermostatic air venting for large process or heating equipment.**

1. Double-seated valve with heat-treat hardened valve seat and valve head provides continuous, smooth, low-velocity condensate discharge as process loads vary.
2. Self-aligning valve mechanism with stainless steel internals minimizes wear.
3. Thermostatic bimetal air vent valve vents air automatically for rapid startup.
4. Easy, inline access to internal parts simplifies cleaning and reduces maintenance costs.
5. High-quality stainless steel internals and hardened valve surfaces ensure reliability.
6. The built-in screen eliminates the need for an external strainer.

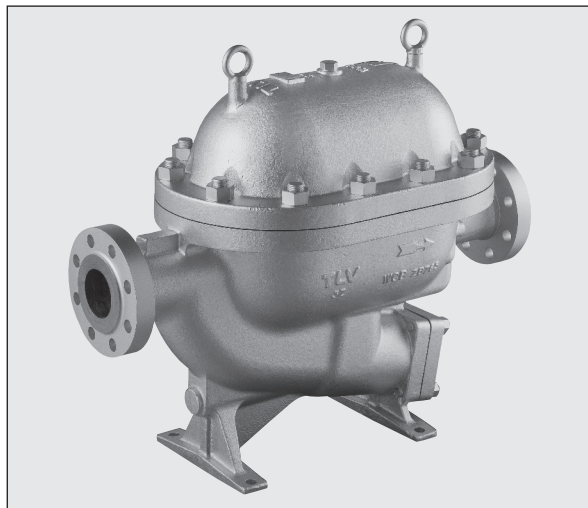

#### Specifications

Model	JLH15	
Connection	Flanged	
Size (mm)	80	
Orifice No.	50	
Maximum Operating Pressure (MPaG)	PMO	5.0
Maximum Differential Pressure (MPa)	ΔPMX	5.0
Minimum Operating Pressure (MPaG)	0.01	
Maximum Operating Temperature (°C)	TMO	425

PRESSURE SHELL DESIGN CONDITIONS (**NOT** OPERATING CONDITIONS):

Maximum Allowable Pressure (MPaG) PMA: 5.0

Maximum Allowable Temperature (°C) TMA: 425

1 MPa = 10.197 kg/cm<sup>2</sup>



#### CAUTION

To avoid abnormal operation, accidents or serious injury, DO NOT use this product outside of the specification range. Local regulations may restrict the use of this product to below the conditions quoted.

No.	Description	Material	JIS	ASTM/AISI*
①	Body	Cast Steel	—	A216/A216M Gr.WCB
②	Cover	Cast Steel	—	A216/A216M Gr.WCB
③ <sup>MR</sup>	Cover Gasket	Graphite/Stainless Steel	—/SUS316L	—/AISI316L
④	Cover Bolt	Alloy Steel	—	A193/A193M Gr.B16
⑤	Cover Nut	Carbon Steel	—	A194/A194M Gr.2H
⑥ <sup>FR</sup>	Float/Lever Unit	Stainless Steel/ Cast Stainless Steel	SUS316L/ —	AISI316L/ A351/A351M Gr.CF8
⑦ <sup>MR</sup>	Trap Unit (Main Valve Unit)	Stainless Steel/ Cast Stainless Steel	SUS304/ —	AISI304/ A743/A743M Gr.CA40
⑧ <sup>R</sup>	Air Vent Unit	Stainless Steel	SUS304/420F	AISI304/420F
⑨ <sup>R</sup>	Screen	Stainless Steel	SUS304	AISI304
⑩	Screen Holder	Cast Steel	—	A216/A216M Gr.WCB
⑪ <sup>MR</sup>	Screen Holder Gasket	Graphite/Stainless Steel	—/SUS304	—/AISI304
⑫	Screen Holder Bolt	Cast Steel	—	A193/A193M Gr.B16
⑬	Screen Holder Nut	Carbon Steel	—	A194/A194M Gr.2H
⑭	Cover Plug	Carbon Steel	—	A105/A105M
⑮ <sup>M</sup>	Cover Plug Gasket	Stainless Steel	SUYP	AISI1010
⑯	Nameplate	Stainless Steel	SUS304	AISI304
⑰	Eye Bolt	Stainless Steel	SS400	A307 Gr.B
⑱	Outlet Pipe	Stainless Steel	SUS304	AISI304
⑲	Snap Ring	Stainless Steel	SUS304	AISI304
⑳	Drain Plug	Carbon Steel	—	A105/A105M
㉑ <sup>M</sup>	Drain Plug Gasket	Stainless Steel	SUYP	AISI1010

\* Equivalent

Replacement kits available: (M) maintenance parts, (R) repair parts, (F) float

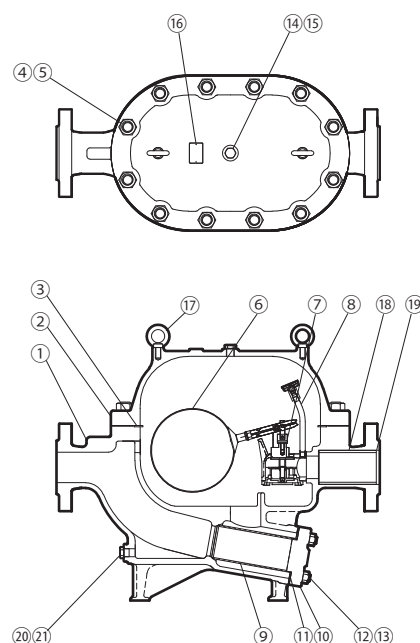

Copyright © TLV

## Dimensions

### • JLH15 Flanged

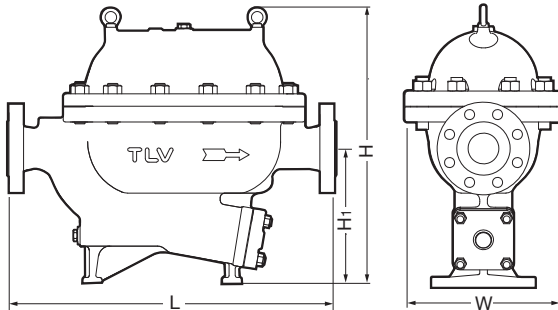

### JLH15 Flanged (mm)

Size	L		H	H <sub>1</sub>	W	Weight (kg)
	ASME Class					
	300RF	600RF				
80	850	850	725	350	408	220

Other standards available, but length and weight may vary

## Discharge Capacity

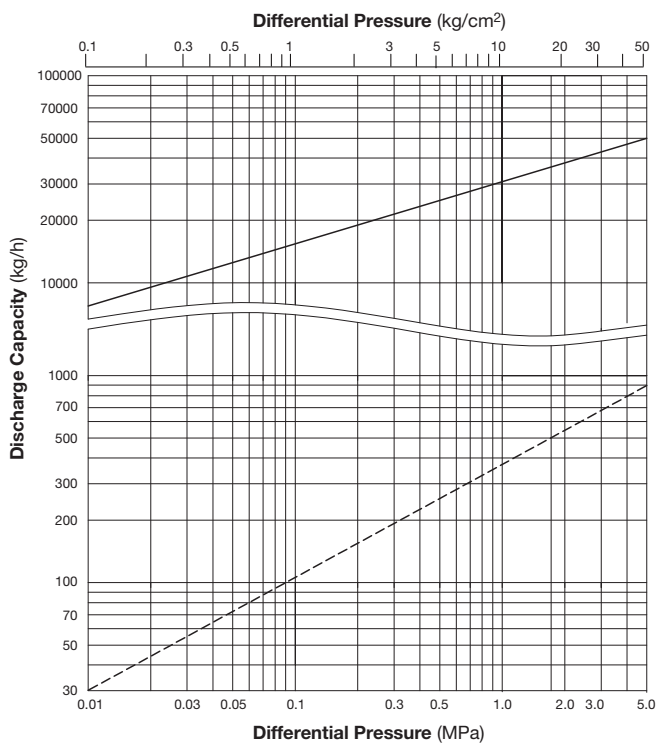

— : Maximum capacity  
 - - - : Minimum amount of condensate required to prevent steam leakage.

1. Line numbers within the graph refer to orifice numbers.
2. Differential pressure is the difference between the inlet and outlet pressure of the trap.
3. Capacities are based on continuous discharge of condensate 6 °C below saturated steam temperature.
4. Recommended safety factor: at least 1.5.



DO NOT use this product under conditions that exceed maximum differential pressure, as condensate backup will occur!