



RAPID INITIAL AIR VENT

MODEL VS1A-M2

RAPID INITIAL AIR VENT FOR LIQUIDS

Features

Stainless steel air vent for vertical installation in liquid systems. Vents large volumes of initial air from liquids above 0.8 S.G.*

1. Precision-ground float, three-point seating and valve seat with rubber contact ensure superior sealing.
2. Unique rotational seating design eliminates concentrated wear.
3. Dual function as air vent and vacuum breaker.
4. Optional high temperature stainless steel valve seat available.**

* Consult TLV for specific gravities lower than 0.8

** Sealing effectiveness may be slightly lowered



Specifications

Model	VS1A-M2	
Connection	Screwed	
Size (mm)	15, 20, 25	
Orifice No.	21	
Maximum Operating Pressure (MPaG)	PMO	2.1
Minimum Operating Pressure (MPaG)	0.01	
Maximum Operating Temperature (°C)	TMO	150 (220 with optional metal seat**)
Applicable Fluids*	Water, other liquids	

* Do not use for toxic, flammable or otherwise hazardous fluids.

1 MPa = 10.197 kg/cm²

** Maximum valve leak rate: 0.50 kg/h

PRESSURE SHELL DESIGN CONDITIONS (NOT OPERATING CONDITIONS): Maximum Allowable Pressure (MPaG) PMA: 2.1
Maximum Allowable Temperature (°C) TMA: 220



To avoid abnormal operation, accidents or serious injury, DO NOT use this product outside of the specification range. Local regulations may restrict the use of this product to below the conditions quoted.

No.	Description	Material	JIS	ASTM/AISI*
①	Body	Cast Stainless Steel	—	A351/A351M Gr.CF8
②	Cover	Cast Stainless Steel	—	A351/A351M Gr.CF8
③	Float	Stainless Steel	SUS316L	AISI316L
④	Valve Seat	Fluorine Rubber/Stainless Steel	FPM/SUS303	D2000HK/AISI303
⑤	Valve Seat Gasket	Fluorine Resin	PTFE	—
⑥	Cover Gasket	Fluorine Resin	PTFE	—
⑦	Cover Bolt	Stainless Steel	—	—
⑧	Nameplate	Stainless Steel	SUS304	AISI304
⑨	Connector	Stainless Steel	SUS304	AISI304
⑩	Screw	Stainless Steel	SUS304	AISI304
⑪	Spring Washer	Stainless Steel	SUS304	AISI304
⑫	Guide Plate	Stainless Steel	SUS304	AISI304

* Equivalent

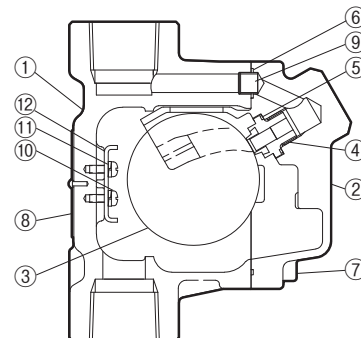

Dimensions

● VS1A-M2 Screwed

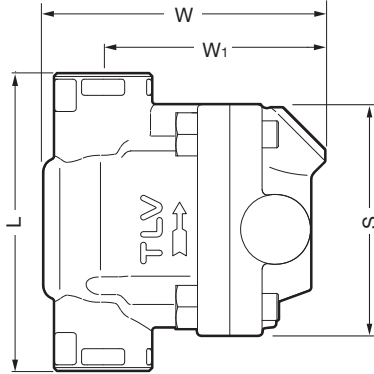

VS1A-M2 Screwed*

(mm)

Size	L	W	W ₁	S	Weight (kg)
15	110	110	85	85	1.5
20	120				
25	130				1.7

* Rc(PT), other standards available

Air Venting Capacity

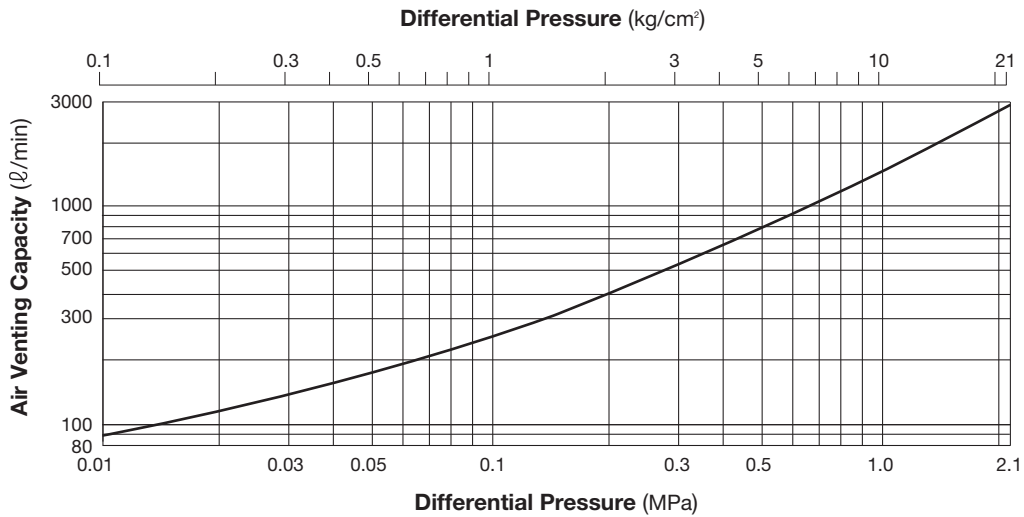

1. Differential Pressure is the difference between the inlet and outlet pressure of the air vent.
2. Capacities are equivalent capacities of air at 20 °C under atmospheric pressure.



Once the valve closes after discharging initial air, it will not open again, even if air accumulates inside the product, until the internal pressure drops to near atmospheric pressure.

Manufacturer
TLV CO., LTD.
 Kakogawa, Japan
 is approved by LRQA Ltd. to ISO 9001/14001

ISO 9001
 ISO 14001

