



PROCESS FLOAT STEAM TRAP

MODEL JLH15 CAST STEEL

HIGH-CAPACITY STEEL FLOAT STEAM TRAP WITH THERMOSTATIC AIR VENTING

Features

Extremely durable, inline-repairable, cobarct float trap with thermostatic air venting for large process or heating equipment.

1. Double-seated valve with heat-treat hardened valve seat and valve head provides continuous, smooth, low-velocity condensate discharge as process loads vary.
2. Self-aligning valve mechanism with stainless steel internals minimizes wear.
3. Thermostatic bimetal air vent valve vents air automatically for rapid startup.
4. Easy, inline access to internal parts simplifies cleaning and reduces maintenance costs.
5. High-quality stainless steel internals and hardened valve surfaces ensure reliability.
6. The built-in screen eliminates the need for an external strainer.

Pressure Equipment Directive (PED)

Classification according to PED 2014/68/EU, fluid group 3

Size	Category	CE marking
DN 80	III	With CE marking and Declaration of Conformity



Specifications

Model	JLH15
Connection	Flanged
Size	DN 80
Orifice No.	50
Maximum Operating Pressure (barg) PMO	50
Maximum Differential Pressure (bar) ΔPMX	50
Minimum Operating Pressure (barg)	0.1
Maximum Operating Temperature (°C) TMO	425

PRESSURE SHELL DESIGN CONDITIONS (NOT OPERATING CONDITIONS):

Maximum Allowable Pressure (barg) PMA: 5.0
Maximum Allowable Temperature (°C) TMA: 425
Minimum Allowable Temperature (°C): 0

1 bar = 0.1 MPa



CAUTION

To avoid abnormal operation, accidents or serious injury, DO NOT use this product outside of the specification range.
Local regulations may restrict the use of this product to below the conditions quoted.

No.	Description	Material	DIN	ASTM/AISI*
①	Body	Cast Steel A216/A216M Gr.WCB	1.0619	—
②	Cover	Cast Steel A216/A216M Gr.WCB	1.0619	—
③ ^{MR}	Cover Gasket	Graphite/Stainless Steel —/SUS316L	—/1.4404	—/AISI316L
④	Cover Bolt	Alloy Steel A193/A193M Gr.B16	1.7711	—
⑤	Cover Nut	Carbon Steel A194/A194M Gr.2H	1.0503	—
⑥ ^{FR}	Float/Lever Unit	Stainless Steel SUS316L/ Cast Stainless Steel A351/A351M Gr.CF8	1.4404/ 1.4312	AISI316L/ —
⑦ ^{MR}	Trap Unit (Main Valve Unit)	Stainless Steel SUS304/ Cast Stainless Steel A743/A743M Gr.CA40	1.4301/ 1.4027	AISI304/ —
⑧ ^R	Air Vent Unit	Stainless Steel SUS304/420F	1.4301/1.4028	AISI304/420F
⑨ ^R	Screen	Stainless Steel SUS304	1.4301	AISI304
⑩	Screen Holder	Cast Steel A216/A216M Gr.WCB	1.0619	—
⑪ ^{MR}	Screen Holder Gasket	Graphite/Stainless Steel SUS304	—/1.4301	—/AISI304
⑫	Screen Holder Bolt	Cast Steel A193/A193M Gr.B16	1.7711	—
⑬	Screen Holder Nut	Carbon Steel A194/A194M Gr.2H	1.0503	—
⑭	Cover Plug	Carbon Steel A105/A105M	1.0460	—
⑮ ^M	Cover Plug Gasket	Stainless Steel SUYP	1.1121	AISI1010
⑯	Nameplate	Stainless Steel SUS304	1.4301	AISI304
⑰	Eye Bolt	Stainless Steel SS400	1.0037	A307 Gr.B
⑱	Outlet Pipe	Stainless Steel SUS304	1.4301	AISI304
⑲	Snap Ring	Stainless Steel SUS304	1.4301	AISI304
⑳	Drain Plug	Carbon Steel A105/A105M	1.0460	—
㉑ ^M	Drain Plug Gasket	Stainless Steel SUYP	1.1121	AISI1010

* Equivalent

Replacement kits available: (M) maintenance parts, (R) repair parts, (F) float

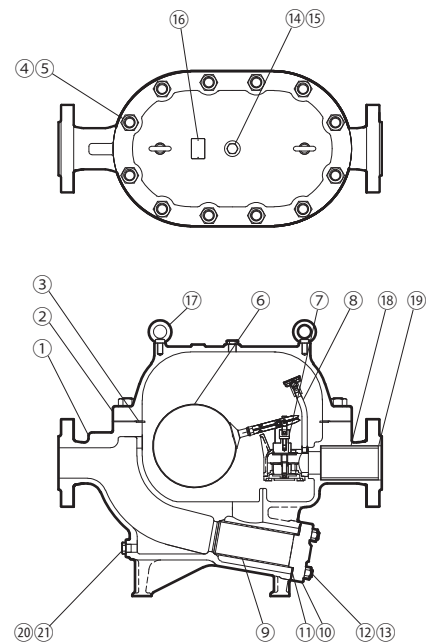

Copyright © TLV

Dimensions

• JLH15 Flanged

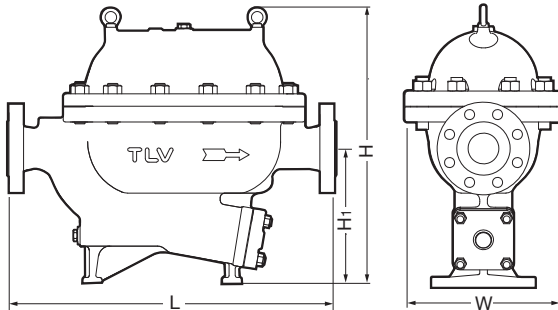

JLH15 Flanged (mm)

DN	L				H	H ₁	W	Weight (kg)
	DIN 2501		ASME Class					
	PN63RF	PN160RF	300RF	600RF				
80	850	850	850	850	725	350	408	220

Other standards available, but length and weight may vary

Discharge Capacity

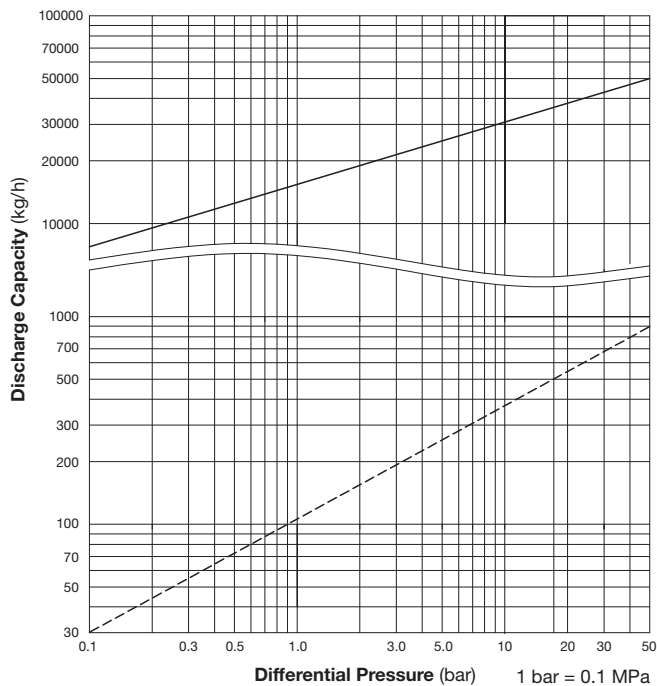

- : Maximum capacity
- - - : Minimum amount of condensate required to prevent steam leakage.

1. Line numbers within the graph refer to orifice numbers.
2. Differential pressure is the difference between the inlet and outlet pressure of the trap.
3. Capacities are based on continuous discharge of condensate 6 °C below saturated steam temperature.
4. Recommended safety factor: at least 1.5.



DO NOT use this product under conditions that exceed maximum differential pressure, as condensate backup will occur!

Manufacturer

TLV® CO., LTD.
Kakogawa, Japan

is approved by LRQA Ltd. to ISO 9001/14001

ISO 9001
ISO 14001

