



# BALANCED PRESSURE THERMOSTATIC STEAM TRAP

## MODEL LV8/LV8-HC STAINLESS STEEL

### BALANCED PRESSURE THERMOSTATIC STEAM TRAP WITH "FAIL-OPEN" DESIGN

#### Features

**All stainless steel thermostatic trap suitable for applications where the condensate load is relatively small, e.g. tracing, vessels and heaters. Preferably for vertical installation.**

1. "Fail open" feature.
2. Rugged yet light construction withstands superheat and water hammer.
3. Cyclic operation with fixed subcooling throughout entire pressure range.
4. Outstanding air venting capability.
5. Compact, yet high capacity.
6. Easy to maintain and easy to clean.
7. Hardened stainless steel valve surfaces.
8. Built-in screen with large surface area.



#### Pressure Equipment Directive (PED)

Classification according to PED 2014/68/EU, fluid group 2

Size	Category	CE marking
DN 8 to DN 25	—*	Art. 4, Sec. 3 (sound engineering practice), CE marking not allowed

\* Manufactured in accordance with sound engineering practice

#### Specifications

Model	LV8	LV8-HC
Connection	Screwed	
Size	1/4", 3/8", 1/2", 3/4", 1"	1/2", 3/4", 1"
Max. Operating Press. (barg) PMO	8.0	
Min. Operating Press. (barg)	0.1	
Maximum Back Pressure	90% of Inlet Pressure	
Max. Operating Temp. (°C) TMO	see graph at right	
Subcooling of X-element Fill (°C)	up to 2 (option: up to 6)	up to 2
Type of X-element	C2C (option: C6)	C2HC

1 bar = 0.1 MPa

**PRESSURE SHELL DESIGN CONDITIONS (NOT OPERATING CONDITIONS):**

Maximum Allowable Pressure (barg) PMA: 25

Maximum Allowable Temperature (°C) TMA: 425

Minimum Allowable Temperature (°C): -40



To avoid abnormal operation, accidents or serious injury, DO NOT use this product outside of the specification range.  
Local regulations may restrict the use of this product to below the conditions quoted.

No.	Description	Material	DIN	ASTM/AISI*
①	Body	Cast Stainless Steel A351/A351M Gr.CF8	1.4312	—
②	Cover	Cast Stainless Steel A351/A351M Gr.CF8	1.4312	—
③	X-element	Stainless Steel	—	—
④	Valve Seat	Stainless Steel SUS316L	1.4542	AISI316L
⑤	Screen	Stainless Steel SUS304	1.4301	AISI304
⑥	Nameplate	Stainless Steel SUS304	1.4301	AISI304

\* Equivalent

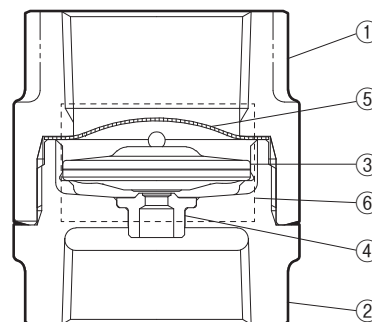
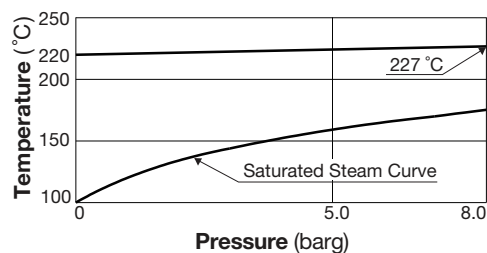

Dimensions

• LV8/LV8-HC Screwed

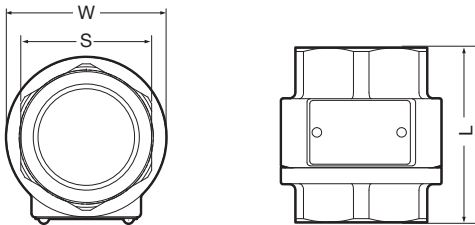

LV8/LV8-HC Screwed\* (mm)

Size	L	φ W	S	Weight (kg)
1/4" **	55	50	27	0.4
3/8" **				
1/2"				
3/4"			41	0.6
1"				0.5

\* BSP DIN 2999, other standards available  
\*\* LV8 only

Discharge Capacity

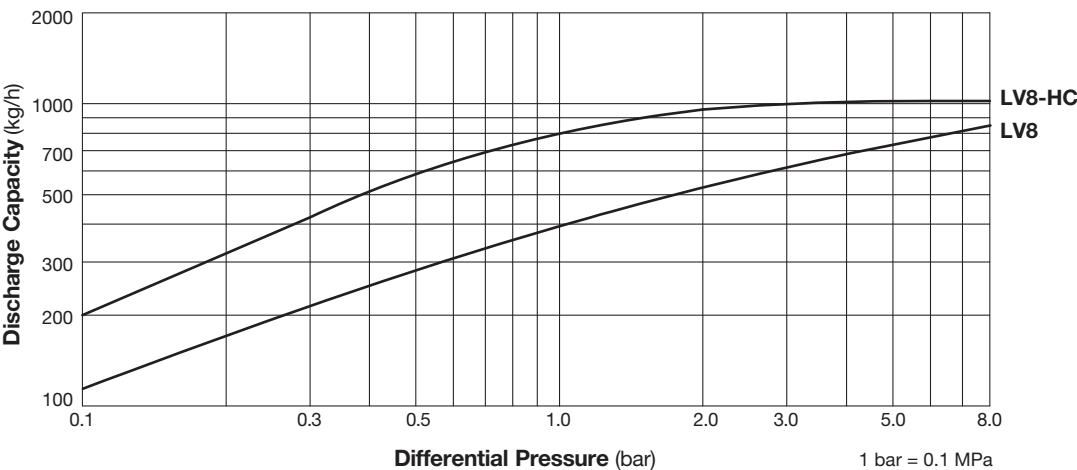

- 1. Differential pressure is the difference between the inlet and outlet pressure of the trap.
- 2. Recommended safety factor: at least 2.

Manufacturer

**TLV® CO., LTD.**

Kakogawa, Japan

is approved by LRQA Ltd. to ISO 9001/14001

ISO 9001  
ISO 14001

**LRQA**  
CERTIFIED