



# SIGHT GLASS

MODEL **SG880** CAST IRON  
CAST STEEL  
STAINLESS STEEL

## COMPACT SIGHT GLASS FOR OPTICAL FLOW CONTROL

### Features

For visual inspection of filling and flow in pipelines. Enables reliable monitoring of the function and performance of individual devices as well as entire systems.

1. Approved according to standard DIN 3237-1
2. With in-built embedded entry.
3. Heat resistant borosilicate glass with mica shield on both sides according to DIN 7080
4. Face-to-face length according to DIN EN 558 FTF1.
5. Light, compact construction.



### Specifications

Model	SG880-16	SG880-40
Connection	Flanged PN16 DIN EN 1092-2	Flanged PN40 DIN EN 1092-2
Body Material	Cast Iron EN-GJL-250	Cast Steel GP240GH/Stainless Steel 1.4408
Size	DN15 to DN50*	
Operating Temperature Range (°C)	-10 to 280	
Max. Operating Pressure (barg) PMO	16	40

\* Other sizes on request.

1 bar = 0.1 MPa

PRESSURE SHELL CONDITIONS (**NOT** OPERATING CONDITIONS): Maximum Allowable Pressure (barg) PMA: 16 or 40  
Maximum Allowable Temperature (°C) TMA: 280



**CAUTION**

To avoid abnormal operation, accidents or serious injury, DO NOT use this product outside of the specification range. Local regulations may restrict the use of this product to below the conditions quoted.

No.	Description	Material	DIN/EN
①	Body	SG880-16 Cast Iron EN-GJL-250	0.6025
		SG880-40 Cast Steel GP240GH	1.0619
		Stainless Steel	1.4408/1.4301
②	Cover	SG880-16 Cast Iron EN-GJL-250	0.6025
		SG880-40 Cast Steel GP240GH	1.0619
		Stainless Steel	1.4408/1.4301
③	Screw	4.6 / 5.6 gal. or A4-70*	—
④	Nut	Steel	—
⑤	Glass	Borosilicate Glass with Mica Shield	DIN 7080
⑥	Gasket	Graphite	—

\* only for SG880-40 stainless steel

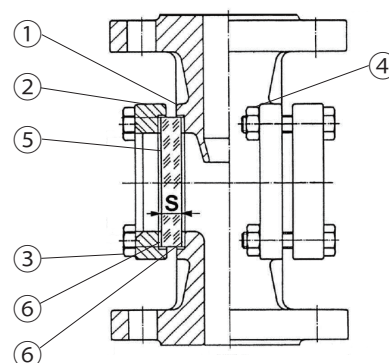

## Dimensions

### ● SG880 Flanged

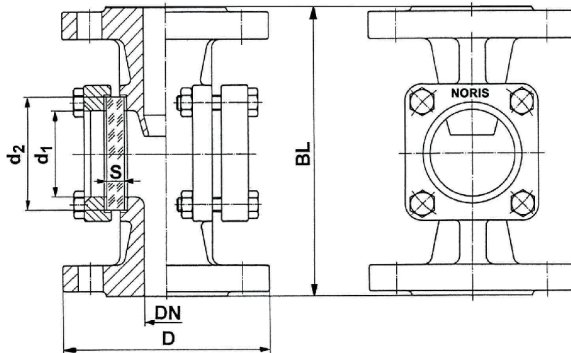

### SG880 Flanged (mm)

DN	D	BL	d <sub>1</sub>	Glass plate		
				d <sub>2</sub>	S	
					PN 16	PN 40
15	95	130	32	45	10	10
20	105	150	32	45	10	10
25	115	160	48	63	10	15
32	140	180	48	63	10	15
40	150	200	65	80	12	20
50	165	230	80	100	15	25

Other sizes on request.

## Max. Operating Pressure / Temperature Relation

(barg)					
Temperature (°C)	120	150	200	250	280
PN16	16.0	15.0	14.0	13.0	11.0
PN40	40.0	37.0	35.0	32.0	28.0

Manufacturer: NORIS Armaturen  
Burkenstein GmbH & Co. KG

**TLV® CO., LTD.**  
Kakogawa, Japan  
is approved by LRQA Ltd. to ISO 9001/14001

ISO 9001  
ISO 14001

