



PROCESS FLOAT STEAM TRAP

MODEL JL14-X/JLH14-X

HIGH-CAPACITY IRON OR STEEL FLOAT & THERMOSTATIC STEAM TRAP

Benefits

Extremely durable, inline-repairable, compact float trap with thermostatic air venting for large process or heating equipment.

1. Double-seated valve with heat-treat hardened valve seat and valve head provides continuous, smooth, low-velocity condensate discharge as process loads vary.
2. Self-aligning valve mechanism with stainless steel internals minimizes wear.
3. Integral thermostatic capsule (X-element) vents air automatically until near-to-steam temperature, for rapid start-up, increased production and even heating.
4. Float with up to 1340 psig hydraulic shock rating ensures excellent resistance to water hammer.
5. Easy, inline access to internal parts simplifies cleaning and reduces maintenance costs.
6. High-quality stainless steel internals and hardened valve surfaces ensure reliability.

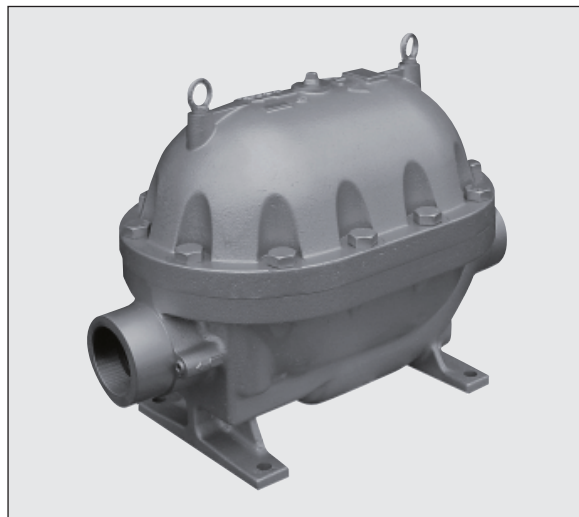

Specifications

Model	JL14-X		JLH14-X		
	Screwed	Flanged*	Screwed	Socket Welded	Flanged
Connection	3	3	3	3	3
Size (in)	3	3	3	3	3
Orifice No.	10, 18		10, 18, 32		
Maximum Operating Pressure (psig) PMO	150, 250		150, 250, 450		
Maximum Differential Pressure (psi) ΔPMX	150, 250		150, 250, 450		
Minimum Operating Pressure (psig)	Vacuum		Vacuum (1.5**)		
Maximum Operating Temperature (°C) TMO	428		464 (752**)		
Maximum Allowable Pressure (psig) PMA	250		450		
Maximum Allowable Temperature (°F) TMA	428		752		

* JL14-X has a screwed-in flange ** Optional JLH14-B with bimetal-type air vent unit for initial air venting

Connections and sizes in bold are standard



To avoid abnormal operation, accidents or serious injury, DO NOT use this product outside of the specification range. Local regulations may restrict the use of this product to below the conditions quoted.

No.	Description	Material	ASTM/AISI*	JIS	
①	Body	JL14-X	Cast Iron	A126 Cl. B	FC250
		JLH14-X	Cast Steel	A216 Gr. WCB	—
②	Cover	JL14-X	Cast Iron	A126 Cl. B	FC250
		JLH14-X	Cast Steel	A216 Gr. WCB	—
③	Cover Gasket	Graphite/Stainless Steel	— / AISI316L	— / SUS316L	
④	Cover Bolt	JL14-X	Carbon Steel	A193 Gr. B7	S45C
		JLH14-X	Alloy Steel	A193 Gr. B7	SNB7
⑤	Float / Lever Unit	Stainless Steel / Cast Stainless Steel	AISI316L / A351 Gr. CF8	SUS316L / —	
⑥	Trap Unit (Main Valve Unit)	Cast Stainless Steel / Stainless Steel	A743 Gr. CA40 / AISI304	— / SUS304	
⑦	Air Vent Unit	Stainless Steel	AISI304/420F	SUS304/420F	
⑧	Cover Plug	JL14-X	Carbon Steel	AISI1010	S10C
		JLH14-X	Carbon Steel	AISI1025	S25C
⑨	Cover Plug Gasket (JLH14-X)	Soft Iron	AISH1010	SUYP	
⑩	Drain Plug	JL14-X	Carbon Steel	AISI1010	S10C
		JLH14-X	Carbon Steel	AISI1025	S25C
⑪	Drain Plug Gasket (JLH14-X)	Soft Iron	AISH1010	SUYP	
⑫	Nameplate	Stainless Steel	AISI304	SUS304	
⑬	Eye Bolt	Carbon Steel	A307 Gr.B	SS400	
⑭	Flange**	Carbon Steel	AISH1025	S25C	
⑮	Flange Pipe**	JL14-X	Carbon Steel	A53 Type S Gr.A	STPG370
		JLH14-X	Stainless Steel	AISI304	SUS304

* Equivalent ** Shown on reverse

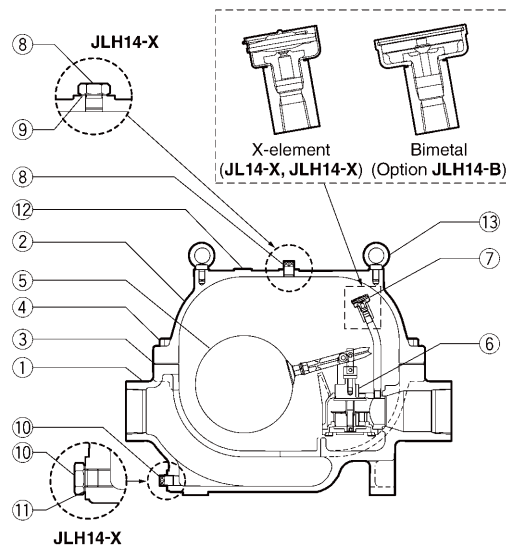

Dimensions

• **JL14-X/JLH14-X** Screwed

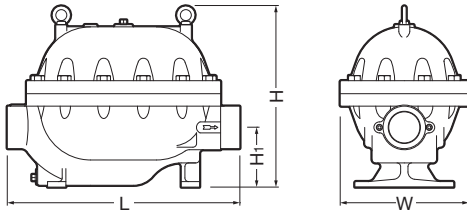

JL14-X shown

• **JLH14-X** Socket Weld

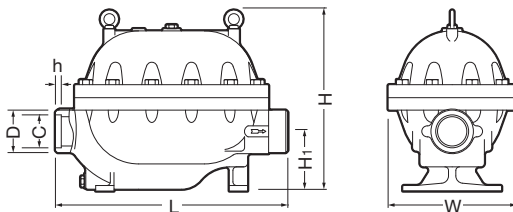

• **JL14-X/JLH14-X** Flanged

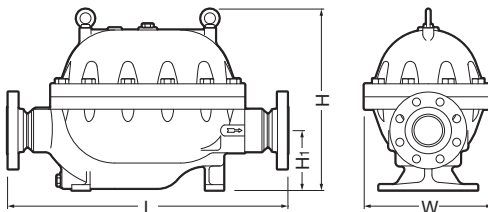

JLH14-X shown

JL14-X/JLH14-X Screwed* (in)

Size	L	H	H ₁	W	Weight (lb)
3	25	19 1/8	6 7/16	13 3/4	236 [243]

* NPT, other standards available
 [] Model JLH14-X

JLH14-X Socket Weld (in)

Size	L	H	H ₁	W	φ D	φ C	h	Weight (lb)
3	25	19 1/8	6 7/16	13 3/4	4 1/8	3.535	5/8	243

• **JL14-X*/JLH14-XX** Flanged (in)

Size	L		H	H ₁	W	Weight** (lb)
	Connects to ASME Class					
	150RF	300RF				
3	30 3/16	30 3/16	19 1/8	6 7/16	13 3/4	267 [273]

Other standards available, but length and weight may vary
 * JL14-X has a screwed-in flange ** Weight is for Class 300 RF
 [] Model JLH14-X

Flange classes in bold are standard

Discharge Capacity

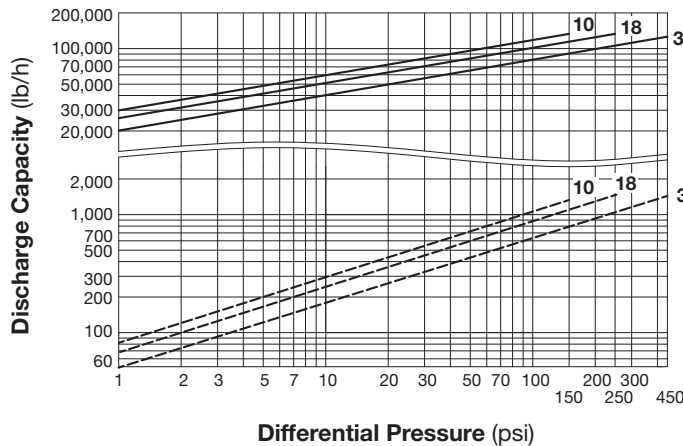

————: Maximum capacity of JL14-X/JLH14-X.
 - - - - -: Minimum amount of condensate required to prevent steam leakage.

1. Line numbers within the graph refer to orifice numbers.
2. Differential pressure is the difference between the inlet and outlet pressure of the trap.
3. Capacities are based on continuous discharge of condensate 11 °F below saturated steam temperature.
4. Recommended safety factor: 1.5.

CAUTION

DO NOT use this product under conditions that exceed maximum differential pressure, as condensate backup will occur!

CAUTION

DO NOT DISASSEMBLE OR REMOVE THIS PRODUCT WHILE IT IS UNDER PRESSURE. Allow internal pressure of this product to equal atmospheric pressure and its surface to cool to room temperature before disassembling or removing. Failure to do so could cause burns or other injury. READ INSTRUCTION MANUAL CAREFULLY.

TLV CORPORATION

13901 South Lakes Drive, Charlotte, NC 28273-6790
 Tel: 704-597-9070 Fax: 704-583-1610
 E-mail: tlv@tlvengineering.com <https://www.tlv.com>
 For Technical Service 1-800 "TLV TRAP"



Manufacturer
TLV CO., LTD.
 Kakogawa, Japan
 is approved by LRQA Ltd. to ISO 9001/14001

