



PowerDyne® STEAM TRAP

MODEL P46S

COMPACT THERMODYNAMIC DISC TRAP

Benefits

Stainless steel trap includes Y-strainer for reliable performance in tracing, instrumentation, and steam mains.

1. Hardened stainless steel working surfaces for long service life.
2. Air-jacketing reduces no-load cycling and extends service life.
3. Lapped disc provides steam-tight seal for long service life.
4. Built-in screen for extended trouble-free service.
5. Installing an optional blowdown valve enables quick and easy removal of scale.



With optional BD1

Specifications

| | | |
|--|-----------------------|--|
| Model | P46S | |
| Connection | Screwed | |
| Size (in) | 1/4, 3/8, 1/2 | |
| Maximum Operating Pressure (psig) PMO | 650* | |
| Minimum Operating Pressure (psig) | 5 | |
| Maximum Operating Temperature (°F) TMO | 800 | |
| Maximum Allowable Pressure (psig) PMA | 650 | |
| Maximum Allowable Temperature (°F) TMA | 800 | |
| Maximum Back Pressure | 80% of Inlet Pressure | |

* For best performance over extended periods, it is recommended that the trap be operated at or below 300 psig.

Connections and sizes in bold are standard



CAUTION

To avoid abnormal operation, accidents or serious injury, DO NOT use this product outside of the specification range. Local regulations may restrict the use of this product to below the conditions quoted.

| No. | Description | Material | ASTM/AISI* | JIS |
|-----------------|----------------------|-----------------------|--------------|----------|
| ① | Body | Cast Stainless Steel | A743 Gr.CA40 | — |
| ② ^R | Cover | Stainless Steel | AISI420F2 | SUS420F2 |
| ③ ^R | Disc | Hardened Stain. Steel | AISI420 | SUS420J2 |
| ④ ^R | Screen | Stainless Steel | AISI430 | SUS430 |
| ⑤ ^{MR} | Screen Holder Gasket | Stainless Steel | AISI316L | SUS316L |
| ⑥ | Screen Holder | Stainless Steel | AISI303 | SUS303 |
| ⑦ ^R | Cap | Stainless Steel | AISI304 | SUS304 |
| ⑧ ^R | Nameplate | Stainless Steel | AISI304 | SUS304 |
| ⑨ | BD1 Blowdown Valve** | Stainless Steel | AISI304 | SUS304 |

* Equivalent ** Option

Replacement kits available: (M) maintenance parts, (R) repair parts,

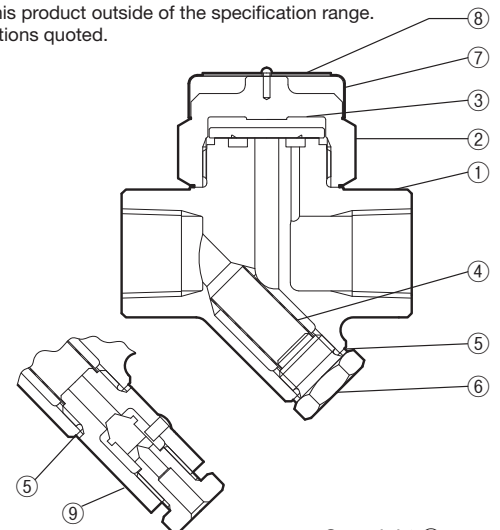

Dimensions

● **P46S** Screwed

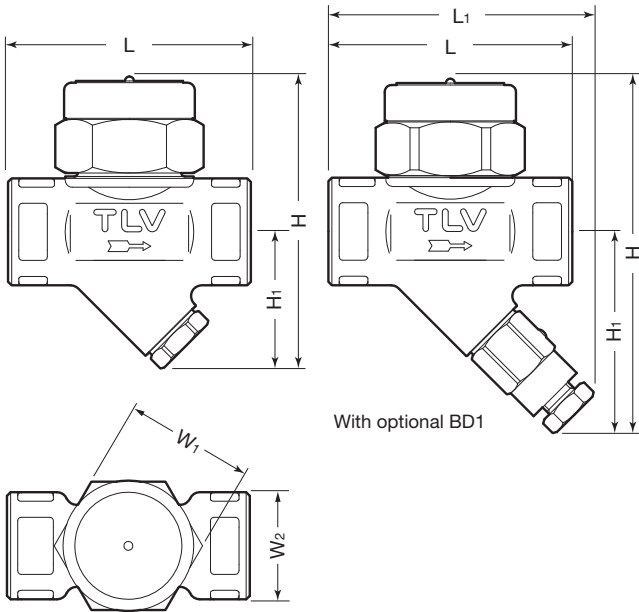

P46S Screwed* (in)

| Size | L | L ₁ | H | H ₁ | W ₁ | W ₂ | Weight (lb) |
|------|---------|----------------|--------------|------------------|----------------|----------------|--------------|
| 1/4 | 2 | (2 1/16) | 3 | 1 7/16 | 1 3/8 | 1 5/16 | 0.8 (0.9) |
| 3/8 | | | (3 3/4) | (2 3/16) | | | |
| 1/2 | 2 11/16 | (2 15/16) | 3 1/4 (4) | 1 1/2 (2 1/4) | | | 1 3/16 |

* NPT, other standards available
() with optional BD1

Discharge Capacity

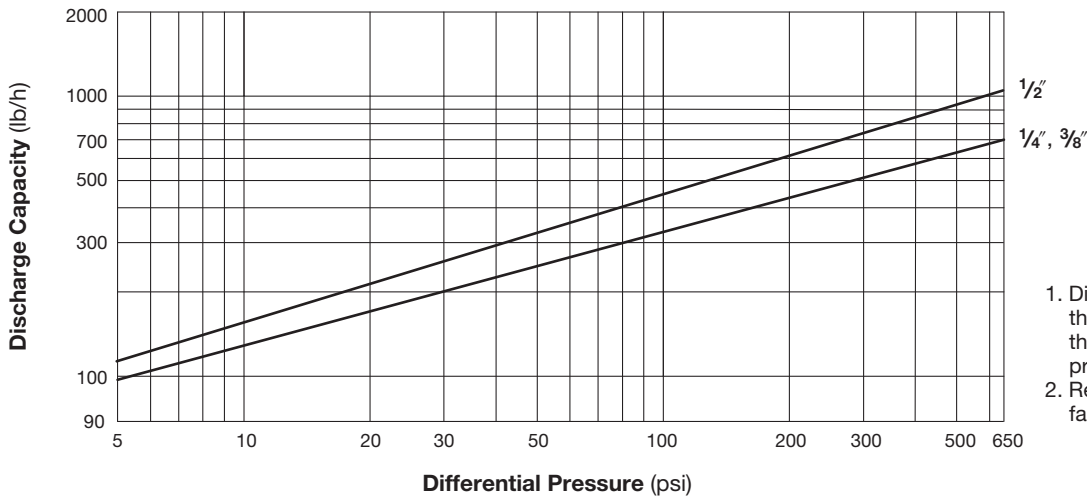

1. Differential pressure is the difference between the inlet and outlet pressure of the trap.
2. Recommended safety factor: at least 2.



CAUTION DO NOT DISASSEMBLE OR REMOVE THIS PRODUCT WHILE IT IS UNDER PRESSURE. Allow internal pressure of this product to equal atmospheric pressure and its surface to cool to room temperature before disassembling or removing. Failure to do so could cause burns or other injury. READ INSTRUCTION MANUAL CAREFULLY

TLV CORPORATION

13901 South Lakes Drive, Charlotte, NC 28273-6790
 Tel: 704-597-9070 Fax: 704-583-1610
 E-mail: tlv@tlvengineering.com <https://www.tlv.com>
 For Technical Service 1-800 "TLV TRAP"



Manufacturer
TLV CO., LTD.
 Kakogawa, Japan
 is approved by LRQA Ltd. to ISO 9001/14001

